

Hi Andrus ,

Regarding Kallaste Arc deadlines ,

27.11.2024

To be clear the repeated extension of the production deadlines for this very technically complex and labor-intensive project is directly related to circumstances influenced by the following:

As you can see by your eyes during your visits to our production and previous correspondence The production requires and has been done and made for each segment assembly - by producing conductors that must be developed and made for each segment, so that the construction pipes can be placed in the required place, because between the plates of each section they are placed twisted and at different heights to form the shape of the arch, without them it is impossible to catch the required dimensions!

As you understand, the development and then production of these conductors additionally takes a lot of time and also are related to costs (which we are not talking about at the moment and in this letter) because each segment requires a unique conductor, and the mirror side once (opposite side) does not fit, because the places of the screws do not match .

To be clear by large, after each stage of assembly, the conductor must be disassembled and the material used in it cannot be used for the next one or can be used only partly.

In addition to these unplanned nuances of the manufacturing work, as you had the opportunity to verify during your visits, we have to perform :

an additional joint assembly of the sections in a screwed manner(by assembling the arch segments together), and only then can we completely weld the connecting plate so that each of the subsequent sections precisely connects and forms the required arch shape with the next section, because each of the connecting plates has an average of 15 to 24 screw locations (without such additional control assembly, there is a huge risk that the arch sections will not be accurately assembled during its installation, because when welding each connecting section plate and if it is not connected to the next one, it has the possibility of warping).

A similar situation is with the arch cladding sheets: after the manufacture of the supporting structures, a strip must be attached to both the inner and outer side edges, additionally and at the required radius, on welded spacers, and each sheet must be unique to a specific numbered location, the pattern of the sheets must also match in nature (in reality) and therefore their control assembly must be carried out, the same applies to the upper and lower planes of the arch. As an additional amount of work and just like the supporting structural segments, the finishing sheets must also be dismantled after control assembly, and only then can they be sent for painting.

These additional and unplanned works then directly affect the overall production times which is too short for such a complex and labor-intensive construction!

As you are well aware and taking this project seriously, we have been doing more than is possible for a long time, we have attracted the maximum possible number of employees to this project for a considerable time, but this is a complex, twisted (3D) metal structure that must be manufactured stage by stage for everything to fit together (not like ordinary metal structures, which can be manufactured regardless of their location in the overall project)!

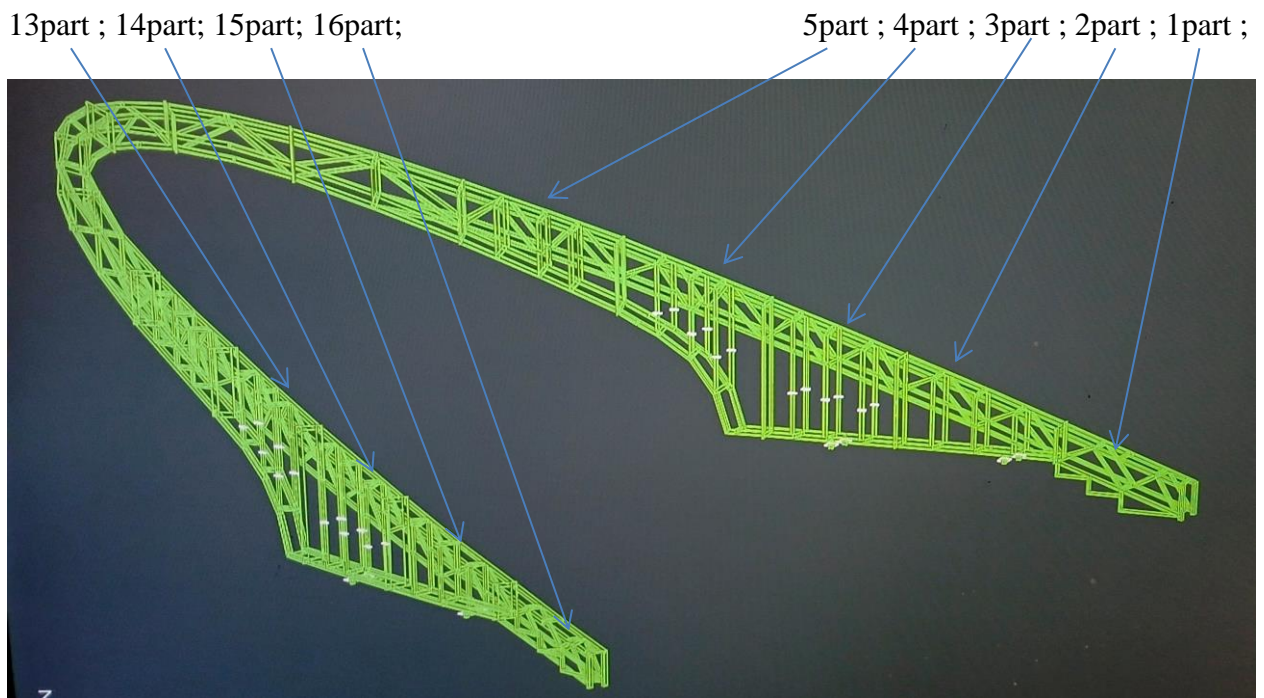

Speaking of the deadlines you are interested in, and taking into account all the above-mentioned circumstances, the total number of structural segments, which is 16, as well as the progress of the work carried out at the moment (the first 5 welded sections of the supporting frame are completely ready, which are sent for further collection of the necessary strips and finishing plates and control assembly + further painting

then on **13.12. 2024** we plan to hand over to you the finished painted **4 first right-hand** sections of the arch structures

(We need to leave part 5 at our factory for now so we can continue and connect the next sections of the arch!)

and on **18-19.12.2024** as earliest to hand over the finished painted 4 sections of the second side (part from 13-16)

The remaining parts 8 pieces (the entire arch) is planned to be handed over by the **end of January 2025**

In parallel with everything please evaluate and notify in writing the need for the delivery of the right and left leg sections and deliver them this year, because their presence with us would help build the overall structure.

With best regards,

Gundars Muižnieks
Executive director

NEOLAT
metal profile

SIA "NEOLAT"

Ostas street 3

Riga, LV 1034

Ph.: +371 67396867

Mob.ph.: +371 28685113

e-mail: gundars@neolat.lv